

COORDINATE POINTS

POINT	NORTH	EAST	POINT	NORTH	EAST	POINT	NORTH	EAST
S-1	8630.00	8016.00	R-2	8615.00	8000.00	RP-1	8289.80	8377.00
S-2	8700.00	8481.14	R-3	8635.40	8025.24	RP-2	8417.81	8029.86
S-3	8847.47	8797.46	R-4	8635.40	8126.24	RP-3	8441.75	8720.56
S-4	8453.65	9063.43	R-5	8635.40	8225.35	RP-4	8576.60	8566.21
S-5	8429.16	9066.50	R-6	8635.40	8326.35	RP-5	8557.32	8953.17
S-6	8862.23	8871.17	R-7	8635.40	8427.35	RP-6	8494.38	8725.24
S-7	8938.55	8898.28	R-8	8665.45	8729.02	RP-7	8789.02	8215.35
S-8	8469.44	9122.36	R-9	8679.45	8758.02	RP-8	8746.77	8786.06
S-9	8448.57	9126.37	R-10	8679.45	8859.02	RP-9	8846.50	8900.07
S-10	8885.19	8943.58	R-11	8679.45	8960.02	RP-10	8608.57	8937.08
S-11	8486.27	9185.14	R-12	8679.45	9061.02	RP-11	8372.90	8926.93
S-12	8440.86	9193.15	R-13	8679.45	9162.02	RP-12	8171.70	8999.19
S-13	8400.93	9201.16	R-14	8679.45	9263.02	RP-13	8196.29	8961.51
S-14	8327.98	9209.17	R-15	8679.45	9364.02	RP-14	7902.52	9007.10
S-15	8168.89	9232.03	R-16	8666.55	9465.02	RP-15	8174.54	9282.21
S-16	8392.50	9127.06	R-17	8469.79	9037.61	RP-16	8642.84	8884.29
S-17	8200.43	8947.69	R-18	8469.79	9138.61	RP-17	8654.67	8984.27
S-18	8138.98	8990.55	R-19	8462.19	9048.75	RP-18	8624.70	9084.50
S-19	8085.58	9152.16	R-20	8377.45	9038.23	RP-19	8513.24	9047.43
S-20	8180.41	9058.81	R-21	8249.37	8985.04	S-1	8227.75	8760.54
S-21	8102.36	9047.80	R-22	8212.39	8956.15	S-2	8606.81	8291.27
S-22	8392.06	9258.83	R-23	8192.04	8913.84	S-3	8298.26	8478.21
S-23	8377.86	9266.80	R-24	8179.51	8887.74	S-4	8449.18	8932.27
S-24	8120.39	9190.13	R-25	8081.68	8842.51	PL-1	8942.17	9012.15
S-25	8131.00	8989.03	R-26	8081.68	8943.51	PL-2	8204.89	8988.84
S-26	8026.80	8568.21	R-27	8067.03	8546.12	PL-3	8008.79	9127.75
S-27	8096.12	8942.38	R-28	7988.80	8466.80	PL-4	7787.04	9273.26
S-28	7966.18	8534.45	R-29	7881.41	8388.24	PL-5	7971.20	9187.82
S-29	8068.75	9000.74	R-30	8188.24	8893.15	PL-6	7720.88	8909.83
S-30	7803.17	8507.22	R-31	8150.22	8901.82	PL-7	7719.56	8389.83
S-31	8101.35	8545.61	R-32	8140.22	8919.14	PL-8	7884.84	8328.07
S-32	8280.52	8371.90	R-33	8042.70	8928.84	PL-9	7882.84	8328.07
S-33	8382.33	8381.36	R-34	8017.10	9131.34	PL-10	8782.47	7982.25
S-34	8301.76	8370.87	R-35	7972.64	9163.00	PL-11	8616.14	7928.64
S-35	8328.24	8354.37	R-36	7777.51	9246.78	PL-12	9041.70	7842.47
S-36	8365.61	8331.86	R-37	8431.70	8548.29	PL-13	8946.49	8667.73
S-37	8060.78	8511.50	R-38	8358.81	8186.57	PL-14	8068.81	7988.43
S-38	8360.15	8234.48	R-39	8355.39	8180.28	PL-15	8012.81	7881.12
S-39	7981.99	8482.52	R-40	8362.32	8184.17	PL-16	8944.70	7986.44
S-40	8337.03	8214.07	R-41	8327.47	8182.14	PL-17	8802.22	7892.31
S-41	8643.57	8330.54	R-42	8272.27	8924.56	PL-18	7908.98	8061.14
S-42	8608.47	8299.35	R-43	8243.85	8934.28	PL-19	8654.25	8389.84
S-43	8687.88	8285.89	R-44	8223.01	8929.20	PL-20	7764.83	8389.74
S-44	8781.85	8438.02	R-45	8491.88	9002.37	PL-21	7728.68	8414.79
S-45	8589.45	8014.58	R-46	8474.47	9015.86	PL-22	7740.58	9046.95
S-46			R-47	8451.25	9031.81			

CURVE DATA

CURVE	RP	RADIUS	LENGTH	ANGLE	CURVE	RP	RADIUS	LENGTH	ANGLE
S-3 TO S-4	1	710.00	480.18	38°49'00"	S-31 TO S-32	5	450.00	247.80	28°49'00"
S-4 TO S-5	2	138.49	14.82	0°07'53"	S-32 TO S-33	5	448.00	22.60	2°18'31"
S-5 TO S-6	1	710.00	473.86	38°15'00"	S-33 TO S-34	5	448.00	68.00	6°09'33"
S-6 TO S-7	2	199.49	21.35	0°07'53"	S-34 TO S-35	5	448.00	68.00	6°09'33"
S-7 TO S-8	1	836.00	472.84	32°23'33"	S-35 TO S-36	5	448.00	445.17	31°28'53"
S-8 TO S-9	1	268.48	481.16	31°15'00"	S-36 TO S-37	6	161.02	78.20	29°40'12"
S-9 TO S-10	3	249.00	178.84	31°00'00"	S-37 TO S-38	6	161.02	68.16	29°40'12"
S-10 TO S-11	1	836.00	472.84	32°23'33"	S-38 TO S-39	6	161.02	78.20	29°40'12"
S-11 TO S-12	1	836.00	472.84	32°23'33"	S-39 TO S-40	6	161.02	78.20	29°40'12"
S-12 TO S-13	1	836.00	472.84	32°23'33"	S-40 TO S-41	6	161.02	78.20	29°40'12"
S-13 TO S-14	3	249.00	178.84	31°00'00"	S-41 TO S-42	6	161.02	78.20	29°40'12"
S-14 TO S-15	1	836.00	472.84	32°23'33"	S-42 TO S-43	6	161.02	78.20	29°40'12"
S-15 TO S-16	1	836.00	472.84	32°23'33"	S-43 TO S-44	6	161.02	78.20	29°40'12"
S-16 TO S-17	1	836.00	472.84	32°23'33"	S-44 TO S-45	6	161.02	78.20	29°40'12"
S-17 TO S-18	1	836.00	472.84	32°23'33"	S-45 TO S-46	6	161.02	78.20	29°40'12"
S-18 TO S-19	1	836.00	472.84	32°23'33"	S-46 TO S-47	6	161.02	78.20	29°40'12"
S-19 TO S-20	3	468.00	246.72	31°00'00"	S-47 TO S-48	6	161.02	78.20	29°40'12"
S-20 TO S-21	1	836.00	472.84	32°23'33"	S-48 TO S-49	6	161.02	78.20	29°40'12"
S-21 TO S-22	1	836.00	472.84	32°23'33"	S-49 TO S-50	6	161.02	78.20	29°40'12"
S-22 TO S-23	1	836.00	472.84	32°23'33"	S-50 TO S-51	6	161.02	78.20	29°40'12"
S-23 TO S-24	3	520.00	260.00	31°00'00"	S-51 TO S-52	6	161.02	78.20	29°40'12"
S-24 TO S-25	1	836.00	472.84	32°23'33"	S-52 TO S-53	6	161.02	78.20	29°40'12"
S-25 TO S-26	1	836.00	472.84	32°23'33"	S-53 TO S-54	6	161.02	78.20	29°40'12"
S-26 TO S-27	1	836.00	472.84	32°23'33"	S-54 TO S-55	6	161.02	78.20	29°40'12"
S-27 TO S-28	1	836.00	472.84	32°23'33"	S-55 TO S-56	6	161.02	78.20	29°40'12"
S-28 TO S-29	1	836.00	472.84	32°23'33"	S-56 TO S-57	6	161.02	78.20	29°40'12"
S-29 TO S-30	4	678.00	531.00	45°00'22"	S-57 TO S-58	6	161.02	78.20	29°40'12"
S-30 TO S-31	1	836.00	472.84	32°23'33"	S-58 TO S-59	6	161.02	78.20	29°40'12"
S-31 TO S-32	1	836.00	472.84	32°23'33"	S-59 TO S-60	6	161.02	78.20	29°40'12"
S-32 TO S-33	1	836.00	472.84	32°23'33"	S-60 TO S-61	6	161.02	78.20	29°40'12"
S-33 TO S-34	1	836.00	472.84	32°23'33"	S-61 TO S-62	6	161.02	78.20	29°40'12"
S-34 TO S-35	1	836.00	472.84	32°23'33"	S-62 TO S-63	6	161.02	78.20	29°40'12"
S-35 TO S-36	1	836.00	472.84	32°23'33"	S-63 TO S-64	6	161.02	78.20	29°40'12"
S-36 TO S-37	1	836.00	472.84	32°23'33"	S-64 TO S-65	6	161.02	78.20	29°40'12"
S-37 TO S-38	1	836.00	472.84	32°23'33"	S-65 TO S-66	6	161.02	78.20	29°40'12"
S-38 TO S-39	1	836.00	472.84	32°23'33"	S-66 TO S-67	6	161.02	78.20	29°40'12"
S-39 TO S-40	1	836.00	472.84	32°23'33"	S-67 TO S-68	6	161.02	78.20	29°40'12"
S-40 TO S-41	1	836.00	472.84	32°23'33"	S-68 TO S-69	6	161.02	78.20	29°40'12"
S-41 TO S-42	1	836.00	472.84	32°23'33"	S-69 TO S-70	6	161.02	78.20	29°40'12"
S-42 TO S-43	1	836.00	472.84	32°23'33"	S-70 TO S-71	6	161.02	78.20	29°40'12"
S-43 TO S-44	1	836.00	472.84	32°23'33"	S-71 TO S-72	6	161.02	78.20	29°40'12"
S-44 TO S-45	1	836.00	472.84	32°23'33"	S-72 TO S-73	6	161.02	78.20	29°40'12"
S-45 TO S-46	1	836.00	472.84	32°23'33"	S-73 TO S-74	6	161.02	78.20	29°40'12"
S-46 TO S-47	1	836.00	472.84	32°23'33"	S-74 TO S-75	6	161.02	78.20	29°40'12"
S-47 TO S-48	1	836.00	472.84	32°23'33"	S-75 TO S-76	6	161.02	78.20	29°40'12"
S-48 TO S-49	1	836.00	472.84	32°23'33"	S-76 TO S-77	6	161.02	78.20	29°40'12"
S-49 TO S-50	1	836.00	472.84	32°23'33"	S-77 TO S-78	6	161.02	78.20	29°40'12"
S-50 TO S-51	1	836.00	472.84	32°23'33"	S-78 TO S-79	6	161.02	78.20	29°40'12"
S-51 TO S-52	1	836.00	472.84	32°23'33"	S-79 TO S-80	6	161.02	78.20	29°40'12"
S-52 TO S-53	1	836.00	472.84	32°23'33"	S-80 TO S-81	6	161.02	78.20	29°40'12"
S-53 TO S-54	1	836.00	472.84	32°23'33"	S-81 TO S-82	6	161.02	78.20	29°40'12"
S-54 TO S-55	1	836.00	472.84	32°23'33"	S-82 TO S-83	6	161.02	78.20	29°40'12"
S-55 TO S-56	1	836.00	472.84	32°23'33"	S-83 TO S-84	6	161.02	78.20	29°40'12"
S-56 TO S-57	1	836.00	472.84	32°23'33"	S-84 TO S-85	6	161.02	78.20	29°40'12"
S-57 TO S-58	1	836.00	472.84	32°23'33"	S-85 TO S-86	6	161.02	78.20	29°40'12"
S-58 TO S-59	1	836.00	472.84	32°23'33"	S-86 TO S-87	6	161.02	78.20	29°40'12"
S-59 TO S-60	1	836.00	472.84	32°23'33"	S-87 TO S-88	6	161.02	78.20	29°40'12"
S-60 TO S-61	1	836.00	472.84	32°23'33"	S-88 TO S-89	6	161.02	78.20	29°40'12"
S-61 TO S-62	1	836.00	472.84	32°23'33"	S-89 TO S-90	6	161.02	78.20	29°40'12"
S-62 TO S-63	1	836.00	472.84	32°23'33"	S-90 TO S-91	6	161.02	78.20	29°40'12"
S-63 TO S-64	1	836.00	472.84	32°23'33"	S-91 TO S-92	6	161.02	78.20	29°40'12"
S-64 TO S-65	1	836.00	472.84	32°23'33"	S-92 TO S-93	6	161.02	78.20	29°40'12"
S-65 TO S-66	1	836.00	472.84						

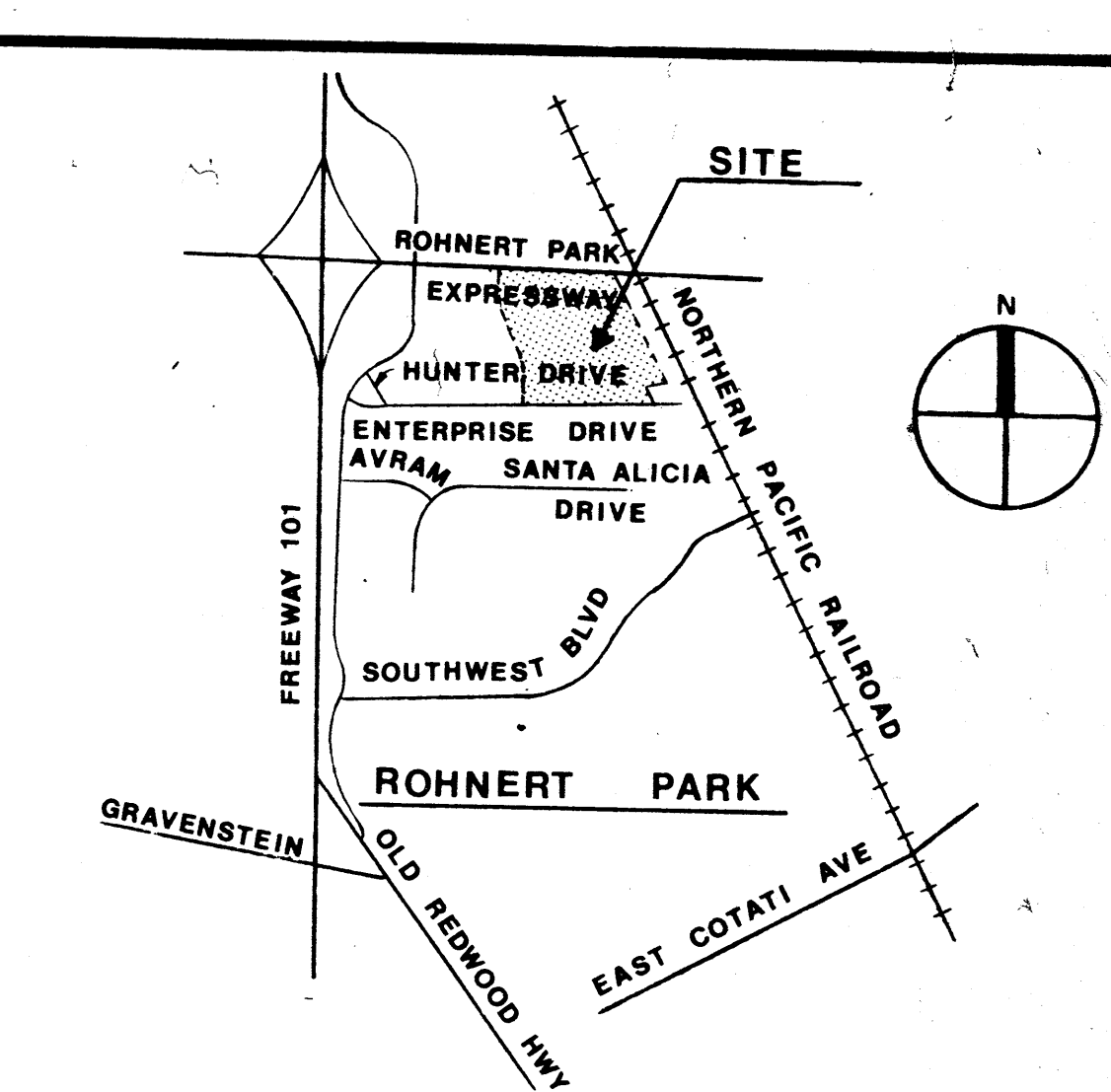
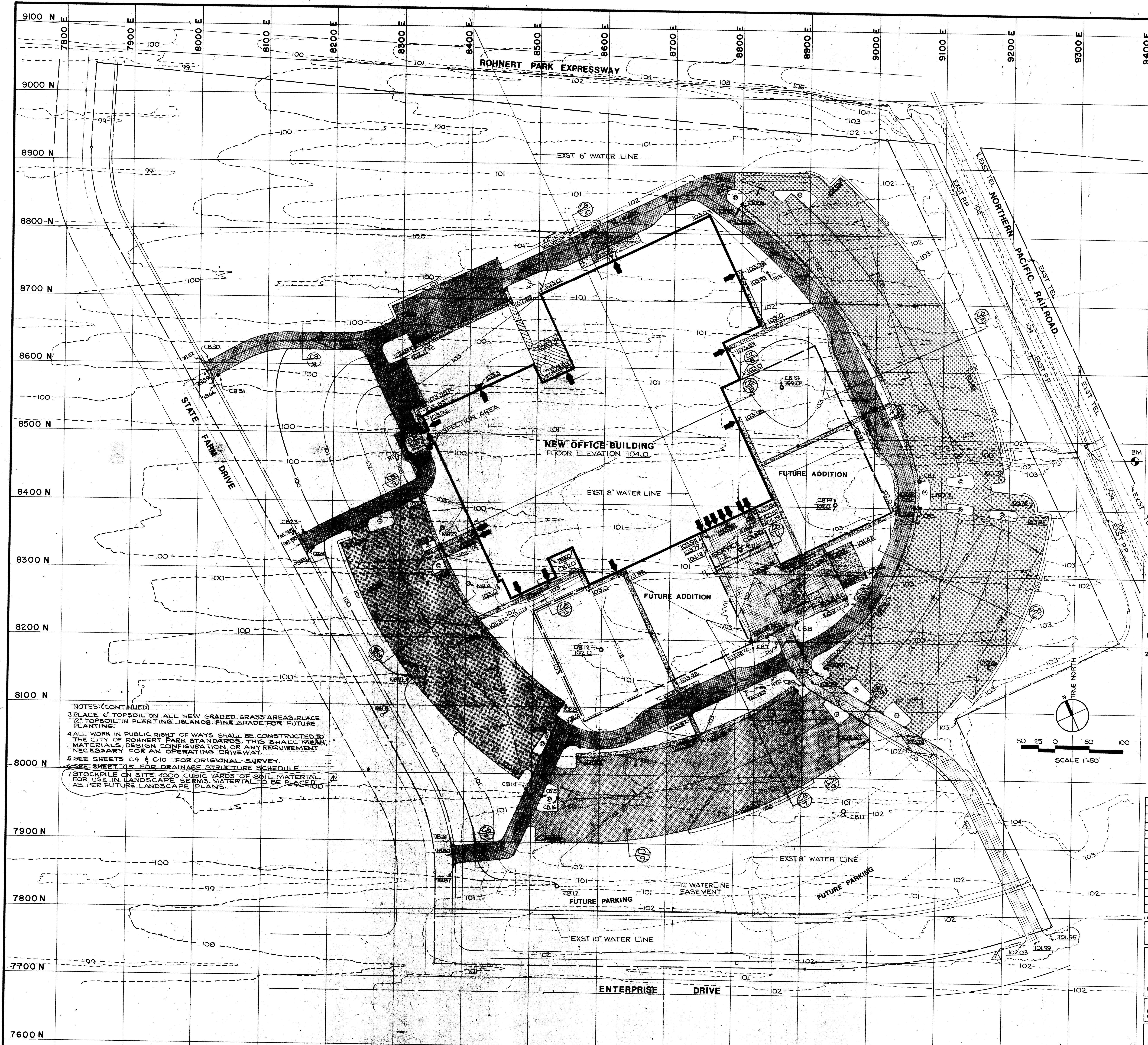

VICINITY MAP
NOT TO SCALE

STANDARD LEGEND - GENERAL CONSTRUCTION

EXISTING	NEW	DESCRIPTION
---	---	PROPERTY LINE
---	---	EASEMENT LINE
---	---	CONSTRUCTION LIMIT
---	---	CONTOUR
---	---	SPOT ELEVATION
---	---	BUILDING
---	---	UNDERGROUND STRUCTURE
---	---	RAILROAD
---	---	CULVERT & END SECTION
---	---	EXPOSED AGGREGATE FINISH
---	---	CONCRETE
---	---	SLOPE DIRECTION
---	---	FENCE
---	---	GUARD RAIL
---	---	TREE-SAVE
---	---	TREE-REMOVE
---	---	DOORWAY
---	---	BENCHMARK LOCATION
---	---	DETAIL REFERENCE
---	---	TRUCK DRIVE & SERVICE COURT AREA
---	---	AUTOMOBILE & LIGHT TRUCK DRIVE
---	---	AUTOMOBILE PARKING
---	---	PLANTING ISLAND
---	---	NUMBER OF CAR STALLS

NOTE:
ITEMS SHOWN ON THIS STANDARD LEGEND MAY NOT APPLY TO THIS PROJECT

- NOTES:
1. BENCHMARK - CHISELED SQUARE IN RAILROAD HEADWALL ON EAST SIDE OF PROPERTY - ELEVATION 104.97
2. ASPHALTIC CONCRETE PAVEMENT SHALL CONFORM TO THE FOLLOWING SECTIONS:

AREA	ASPHALT CONCRETE SURFACING	CLASS 2 AGGREGATE BASE	CLASS 4 AGGREGATE OR LIME-TREATED SUBBASE
TRUCK DRIVEWAY AND SERVICE AREA	2.5"	14.5"	
ALTERNATE	2.5"	7.5"	8.0"
AUTOMOBILE AND LIGHT TRUCK DRIVES	1.5"	11.5"	
ALTERNATE	1.5"	6.0"	6.0"
AUTOMOBILE PARKING	1.5"	8.5"	
ALTERNATE	1.5"	5.0"	4.0"

SEE NOTES CONTINUED @ LEFT

NOTES (CONTINUED)
3. PLACE 6" TOPSOIL ON ALL NEW GRADED GRASS AREAS. PLACE 12" TOPSOIL IN PLANTING ISLANDS. FINE GRADE FOR FUTURE PLANTING.
4. ALL WORK IN PUBLIC RIGHT OF WAYS SHALL BE CONSTRUCTED TO THE CITY OF ROHNERT PARK STANDARDS. THIS SHALL MEAN MATERIALS, DESIGN CONFIGURATION, OR ANY REQUIREMENT NECESSARY FOR AN OPERATING DRIVEWAY.
5. SEE SHEETS C9 & C10 FOR ORIGINAL SURVEY.
6. SEE SHEET C5 FOR DRAINAGE STRUCTURE SCHEDULE.
7. STOCKPILE ON SITE 4000 CUBIC YARDS OF SOIL MATERIAL FOR USE IN LANDSCAPE BERMS. MATERIAL TO BE PLACED AS PER FUTURE LANDSCAPE PLANS.

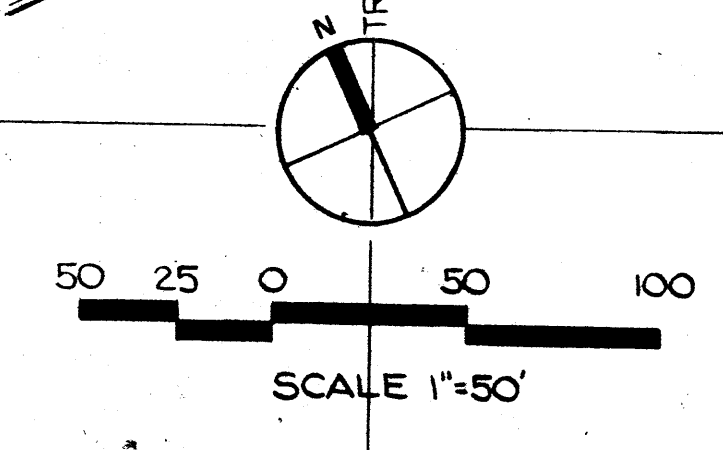

REVISED PER AMMENDMENT NO 1 8-12-76
REVISED PER ADDENDUM NO 1 6-01-76

SITE GRADING PLAN

NORTHERN CALIFORNIA REGIONAL OFFICE
ROHNERT PARK, CALIFORNIA

STATE FARM MUTUAL AUTOMOBILE
INSURANCE COMPANY
BLOOMINGTON, ILLINOIS

R.O. 39-1

WILLIAM R. SHANNON, JR., A.I.A.
REGISTRATION NO. C483 ONE APPLE TREE SQUARE
STATE OF CALIFORNIA BLOOMINGTON, MINNESOTA 55420

DATE: 5-20-76
IN CHARGE: J.D.S.
DRAWN BY: RWQ
CHECKED BY: L.W.E.
COMM. NO.: 5521422D
SHEET NO.: **C4**



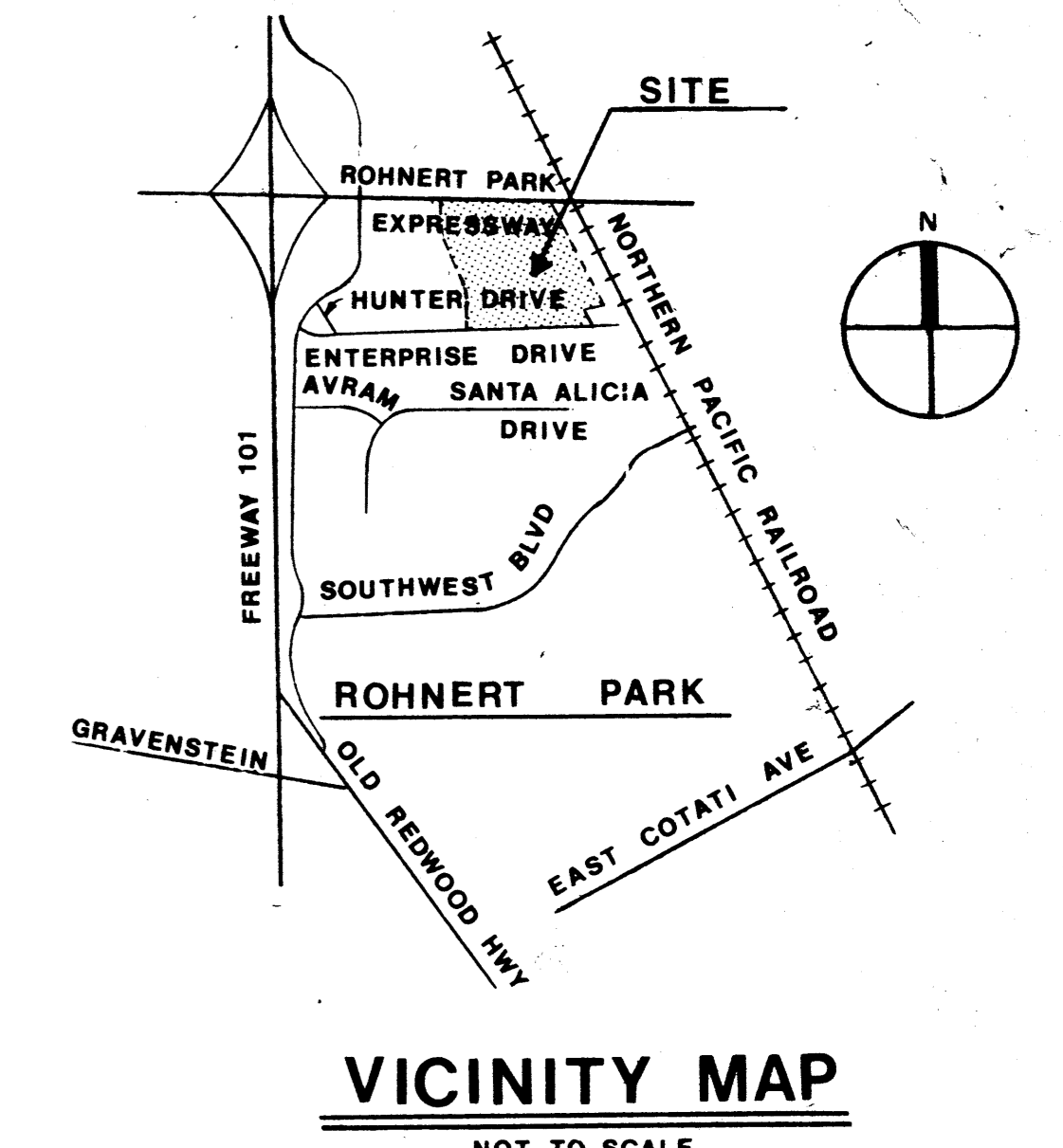
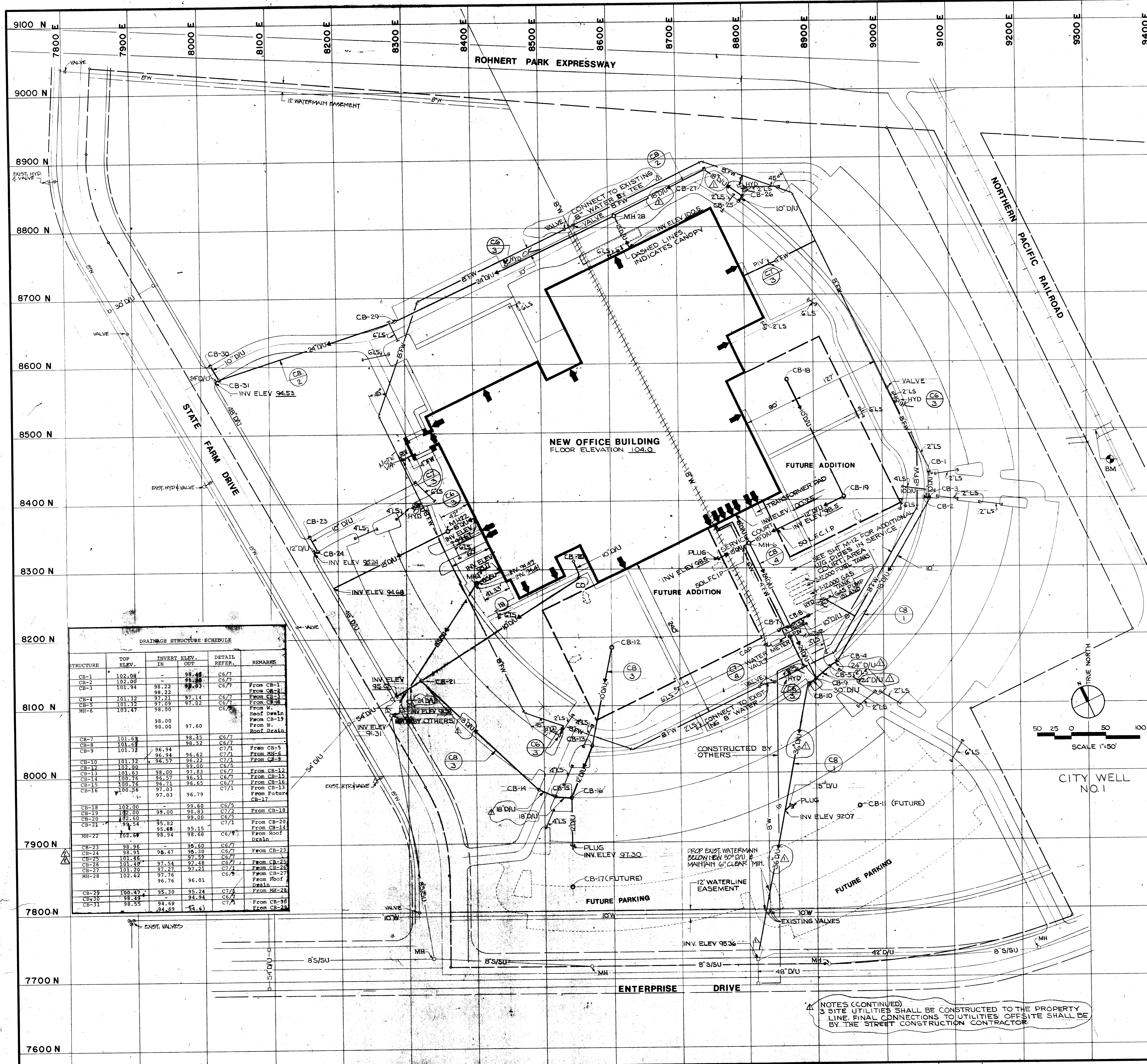

STANDARD LEGEND—MECHANICAL CONSTRUCTION

EXISTING	NEW	DESCRIPTION
—	—	PROPERTY LINE
—	—	EASEMENT LINE
—	—	CONSTRUCTION LIMIT
MH	MH	STORM SEWER—UNDERGROUND
○	○	8" S/SU
○	○	8" S/SU
○	○	18" CS
○	○	18" CS
○	○	6" S/SU FM
○	○	6" S/SU FM
○	○	6" W
○	○	6" W
○	○	6" FW
○	○	4" G
○	○	1 1/2" O
○	○	2" FOS
○	○	1" FOR
○	○	2" GASO
○	○	ELEC
○	○	ELEC U-G
○	○	TEL
○	○	TEL U-G
○	○	C.O.
○	○	1" LS
○	○	8" STM
○	○	3" RET
○	○	DET NO.

REMOVALS

REMOVALS	DESCRIPTION
---	UTILITY TYPE AS NOTED

NOTE:
ITEMS SHOWN ON THIS LEGEND MAY NOT APPLY TO THIS PROJECT.

NOTES:
1. SEE DETAIL C2/7 FOR DETAIL OF SERVICE COURT AREA.

2. LAWN SPRINKLING PIPING.
PIPING SHALL BE INSTALLED UNDER ROADS, PARKING AND WALK AREAS AS SHOWN ON THE DRAWINGS. PIPING SHALL EXTEND A MINIMUM OF TWO FEET INTO THE PLANTING AND LAWN AREAS FOR FUTURE CONNECTION TO THE LAWN SPRINKLING SYSTEM.
PIPES SHALL BE PLASTIC (PVC), CLASS 160. JOINTS SHALL BE PLAIN END SOLVENT WELD TYPE. PLASTIC PIPE FITTINGS AND/OR CONNECTORS SHALL BE MOLDED FITTINGS OF THE SAME MATERIAL AS THE PIPE SUITABLE FOR SOLVENT WELD. P.V.C. SCHEDULE 40 SHALL BE USED.
SOLVENT WELD CEMENT SPECIFICALLY FORMULATED TO SOLVENT WELD PLASTIC PIPE AND FITTINGS SHALL BE USED. CABOT TYPE 40R OR APPROVED EQUAL.
PIPE SHALL BE LAID WITH A MINIMUM COVER OF 24 INCHES FROM FINAL GRADE.
CAP ALL ENDS SECURELY AND STAKE END LOCATIONS FOR FUTURE USE.
ALL PIPE SECTIONS TO BE USED FOR WATER SERVICE SHALL BE PRESSURE TESTED AT 100 P.S.I. PRESSURE TO INSURE LEAK TIGHT CONNECTIONS. ALL LEAKS SHALL BE REPAIRED AND RETESTED UNTIL THE SYSTEM IS FOUND LEAK PROOF. THE CONTRACTOR SHALL VERIFY WITH THE LANDSCAPE ARCHITECT TO DETERMINE WHICH PIPES NEED PRESSURE TESTING.

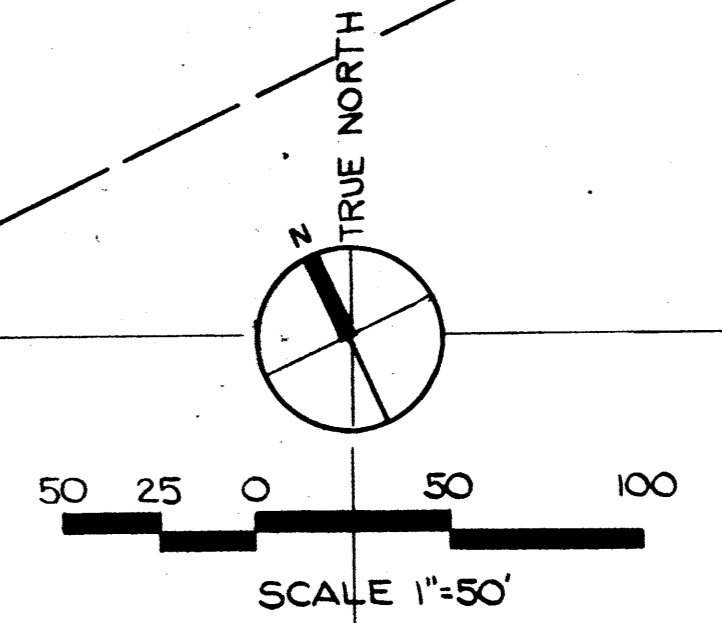

DRAINAGE STRUCTURE SCHEDULE

STRUCTURE	TOP ELEV.	INVERT ELEV. IN	INVERT ELEV. OUT	DETAIL REFER.	REMARKS
CB-1	102.08	-	98.48	C6/7	
CB-2	102.00	98.22	98.22	C6/7	From CB-1
CB-3	101.94	98.22	98.22	C6/7	From CB-2
CB-4	101.32	97.21	97.14	C6/7	From CB-3
CB-5	101.32	97.09	97.02	C6/7	From CB-4
MH-6	101.47	98.00	98.00	C6/7	From Roof Drain
		98.00	97.60		From N. Roof Drain
CB-7	101.69	98.45	98.45	C6/7	
CB-8	101.69	98.32	98.32	C6/7	
CB-9	101.32	96.94	96.62	C7/1	From CB-5
CB-10	101.32	96.94	96.62	C7/1	From MH-6
CB-11	101.32	96.57	96.22	C7/1	From CB-9
CB-12	102.00	98.00	98.00	C6/5	
CB-13	101.63	98.00	97.93	C6/7	From CB-12
CB-14	100.76	96.57	96.51	C6/7	From CB-13
CB-15	100.76	96.71	96.65	C6/7	From CB-14
CB-16	100.56	97.03	96.79	C7/1	From CB-15
CB-17		97.03	96.79		From Future CB-17
CB-18	102.00	99.00	99.60	C6/5	
CB-19	102.00	99.00	99.00	C6/5	From CB-18
CB-20	102.00	95.82	95.82	C7/1	From CB-20
CB-21	102.00	95.82	95.82	C7/1	From CB-20
MH-22	102.68	98.94	98.68	C6/9	From Roof Drain
CB-23	98.36	95.60	95.60	C6/7	
CB-24	98.31	95.47	95.30	C6/7	From CB-23
CB-25	101.46	97.59	97.59	C6/7	
CB-26	101.40	97.54	97.48	C6/7	From CB-25
CB-27	101.20	97.27	97.21	C7/1	From CB-26
MH-28	102.62	97.76	96.01	C6/9	From CB-27
		96.76	96.01		From Roof Drain
CB-29	100.47	95.30	95.24	C7/1	From MH-28
CB-30	98.49	94.69	94.94	C6/7	From CB-29
CB-31	98.55	94.69	94.63	C7/1	From CB-30

NOTES (CONTINUED)
3. SITE UTILITIES SHALL BE CONSTRUCTED TO THE PROPERTY LINE. FINAL CONNECTIONS TO UTILITIES OFFSITE SHALL BE BY THE STREET CONSTRUCTION CONTRACTOR.

REVISION	DATE	INCHARGE

REVISED AS PER AMENDMENT NO. 1 8/27/6
REVISED AS PER ADDENDUM NO. 1 6-21-76

SITE UTILITY PLAN

NORTHERN CALIFORNIA REGIONAL OFFICE
ROHNERT PARK, CALIFORNIA

STATE FARM MUTUAL AUTOMOBILE
INSURANCE COMPANY
BLOOMINGTON, ILLINOIS

R.O. 39-1

WILLIAM R. SHANNON, JR., A.S.A.
REGISTRATION NO. 0485
STATE OF CALIFORNIA BLOOMINGTON, MINNESOTA 55420

DATE 5-20-76
IN CHARGE JDB
DRAWN BY RWO
CHECKED BY LWE
COMM. NO. 5921-6220
SHEET NO. C5

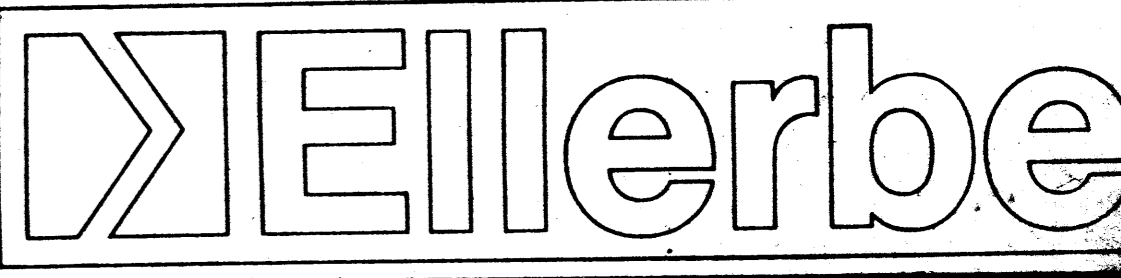

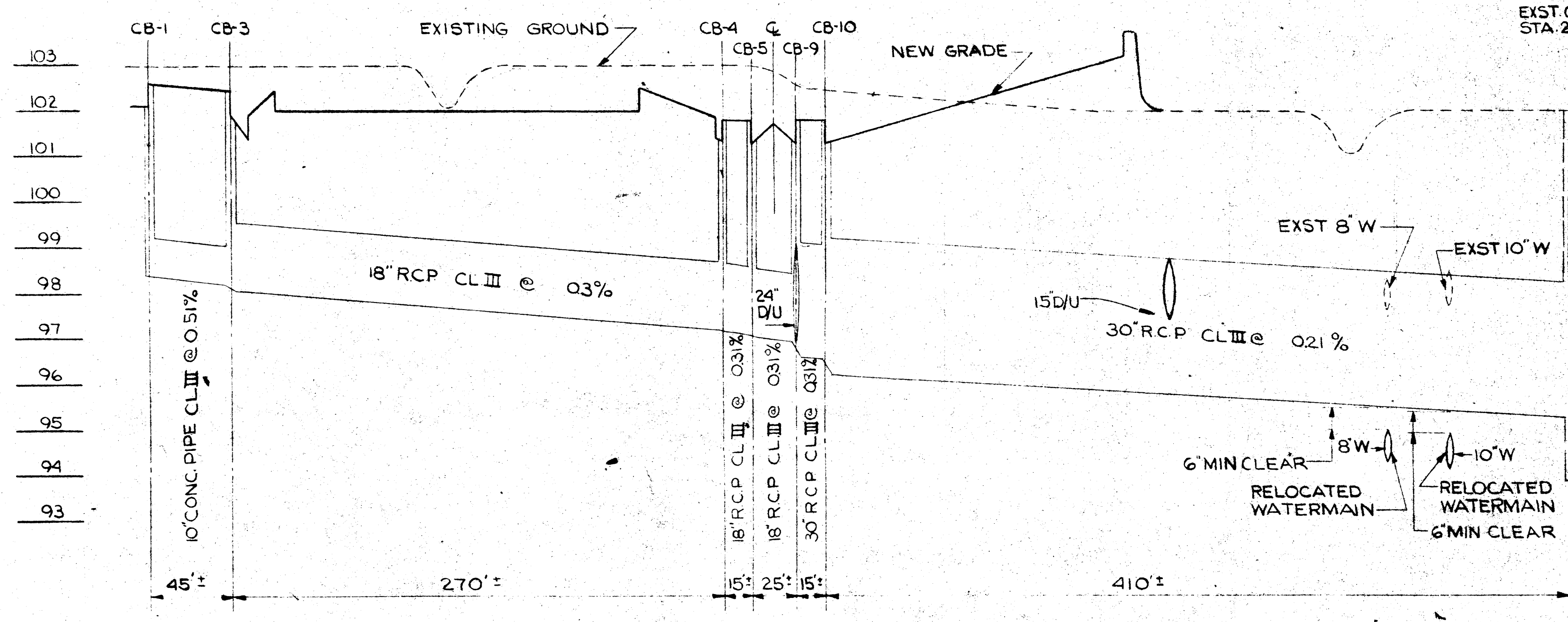

NOTE: VERIFY ALL DISTANCES BETWEEN STRUCTURES IN FIELD

CB 1 STORM SEWER PROFILE
SCALE: HORIZ. 1"=50'
VERT. 1"=2'

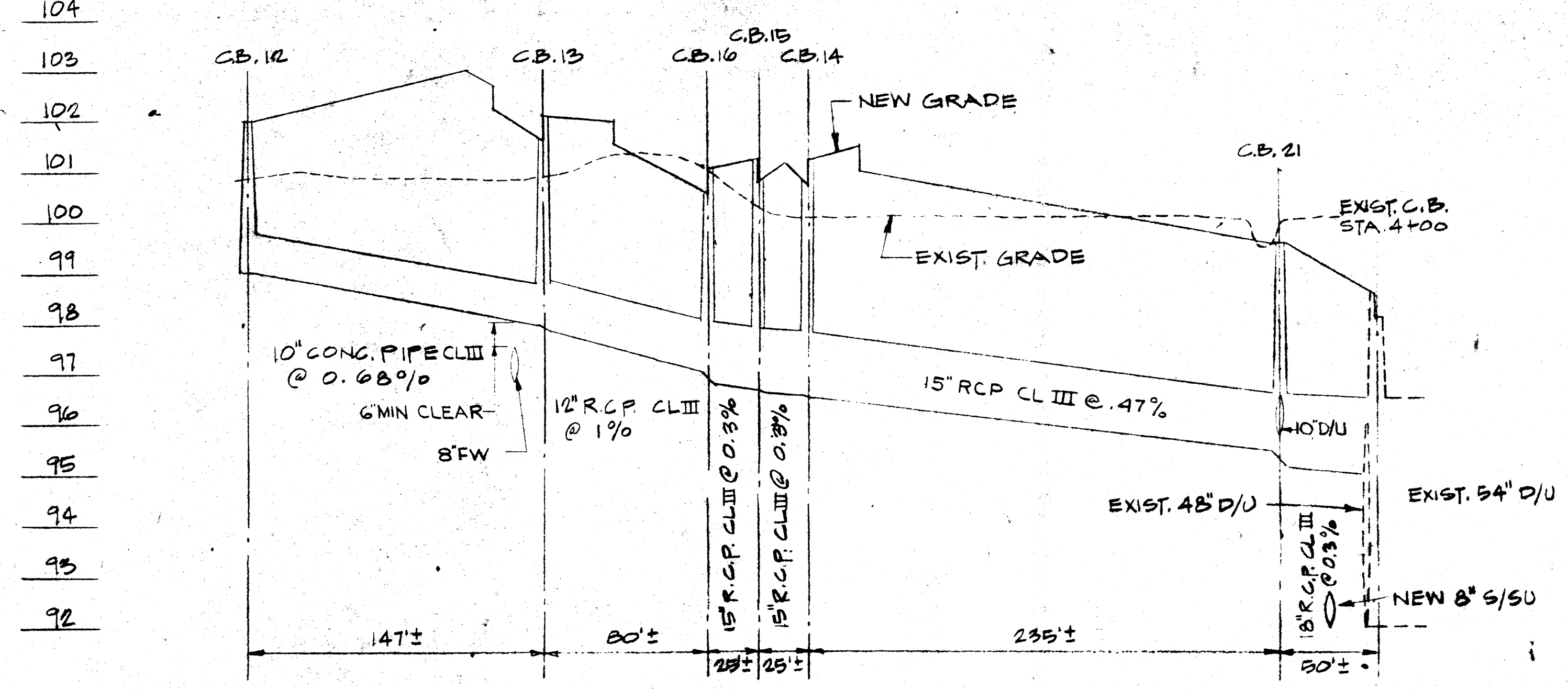

NOTE: VERIFY ALL DISTANCES BETWEEN STRUCTURES IN FIELD

CB 3 STORM SEWER PROFILE
SCALE: HORIZ. 1"=50'
VERT. 1"=2'

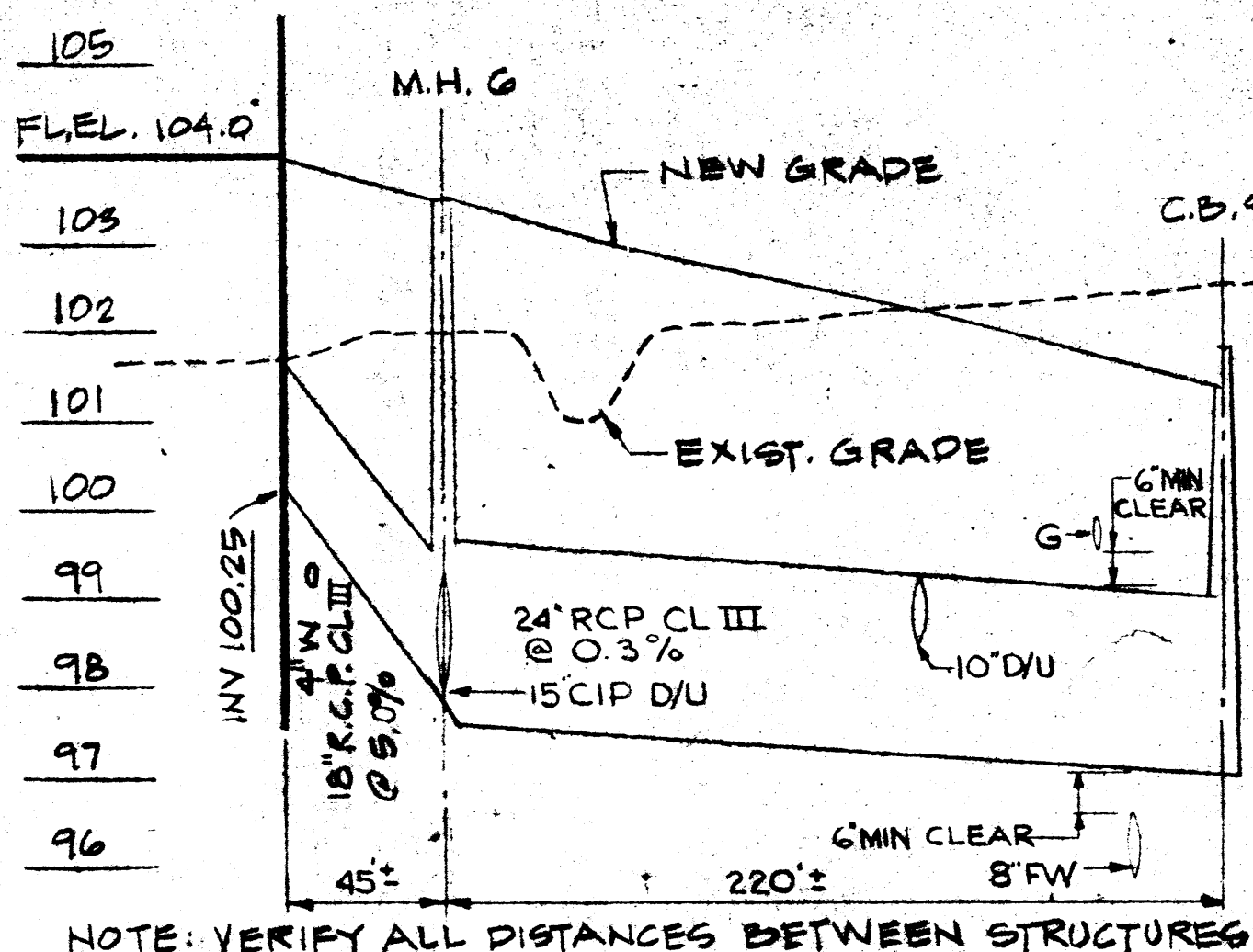

NOTE: VERIFY ALL DISTANCES BETWEEN STRUCTURES IN FIELD

CB 4 STORM SEWER PROFILE
SCALE: HORIZ. 1"=50'
VERT. 1"=2'

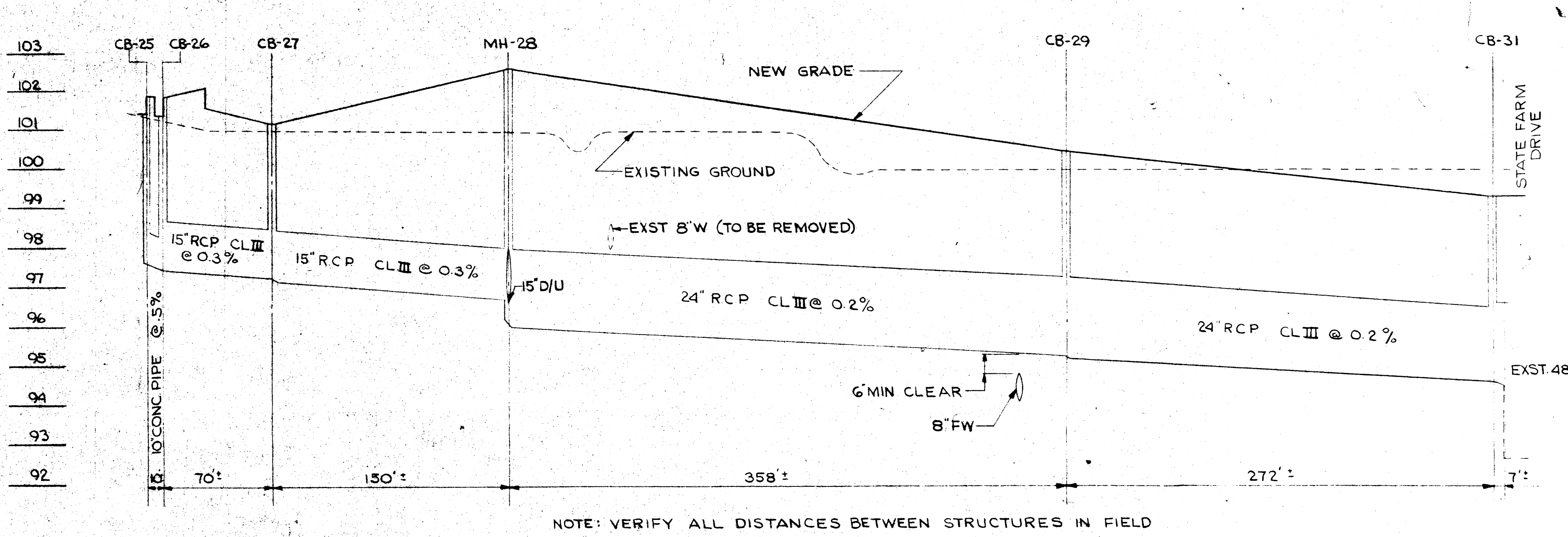

NOTE: VERIFY ALL DISTANCES BETWEEN STRUCTURES IN FIELD

CB 2 STORM SEWER PROFILE
SCALE: HORIZ. 1"=50'
VERT. 1"=2'

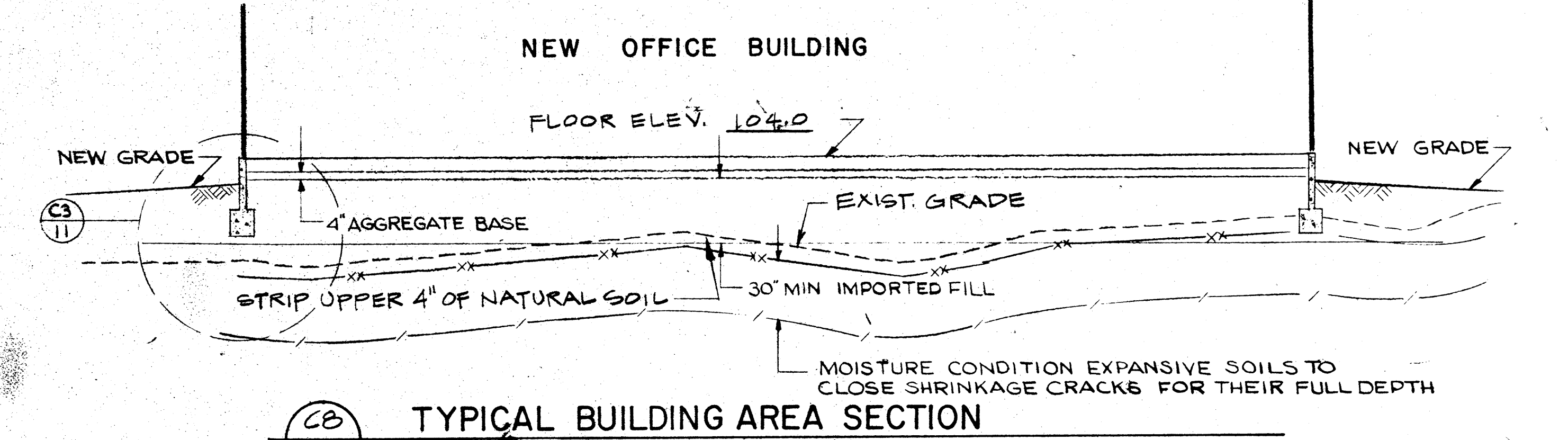

CB 5 TYPICAL BUILDING AREA SECTION
NO SCALE

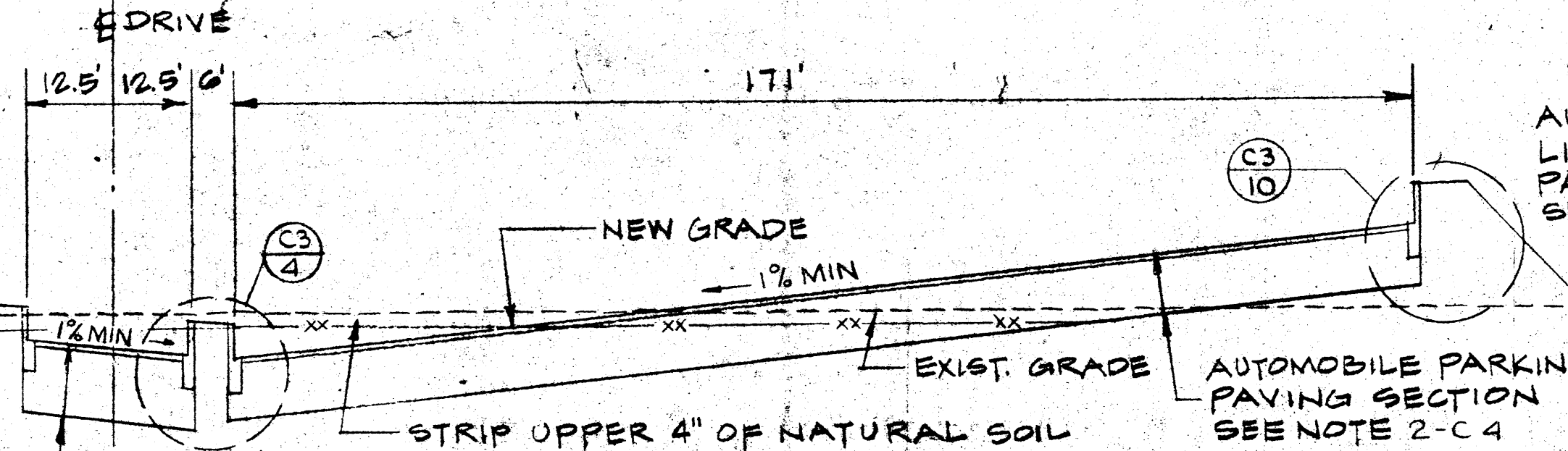

CB 6 TYPICAL DRIVE & PARKING SECTION
NO SCALE

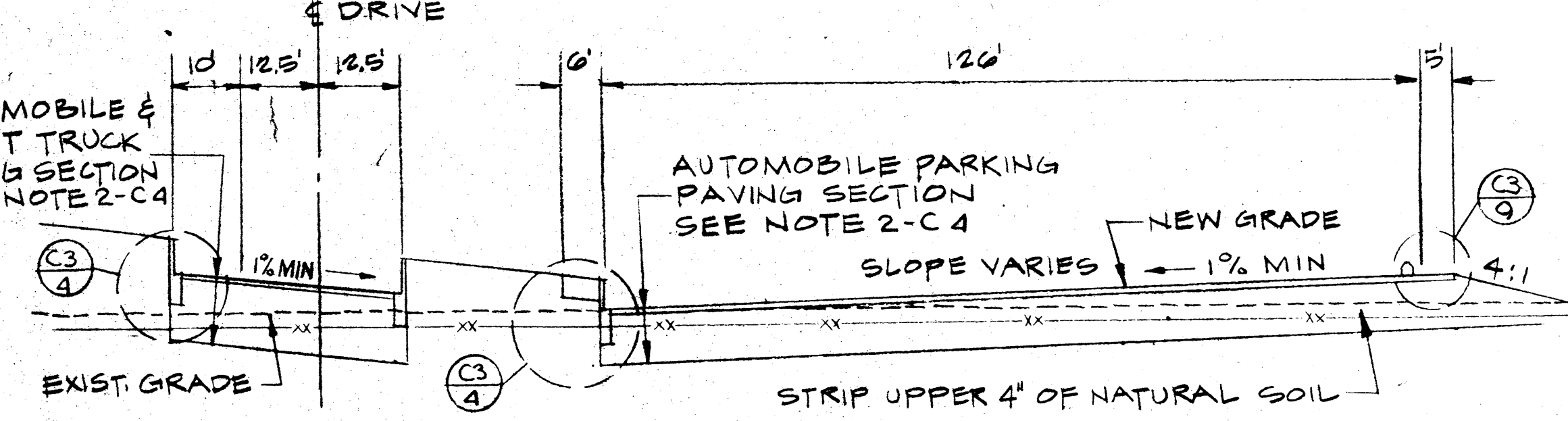

CB 7 TYPICAL DRIVE & PARKING SECTION
NO SCALE

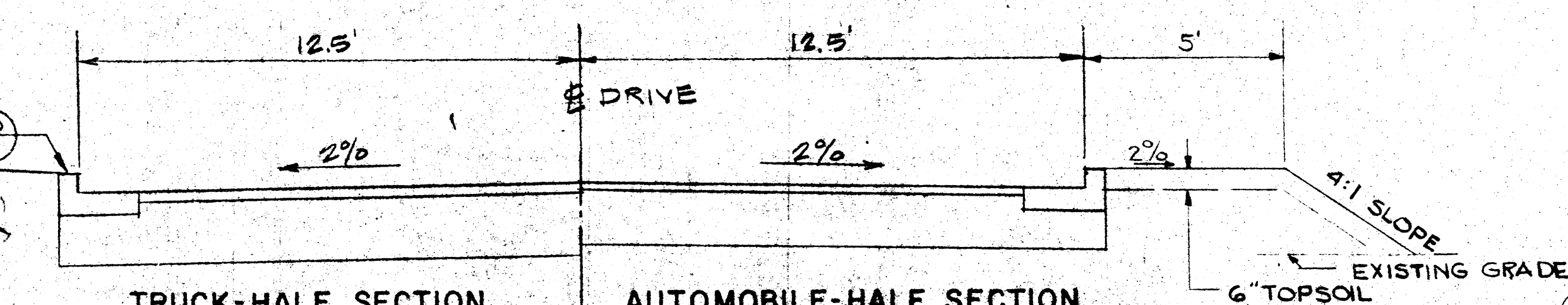

CB 9 TYPICAL DRIVE-HALF SECTIONS
HALF SECTIONS SYMMETRICAL ABOUT CENTER LINE.
SEE NOTE 2 FOR DEPTH OF SECTIONS. SHT. C4
NO SCALE

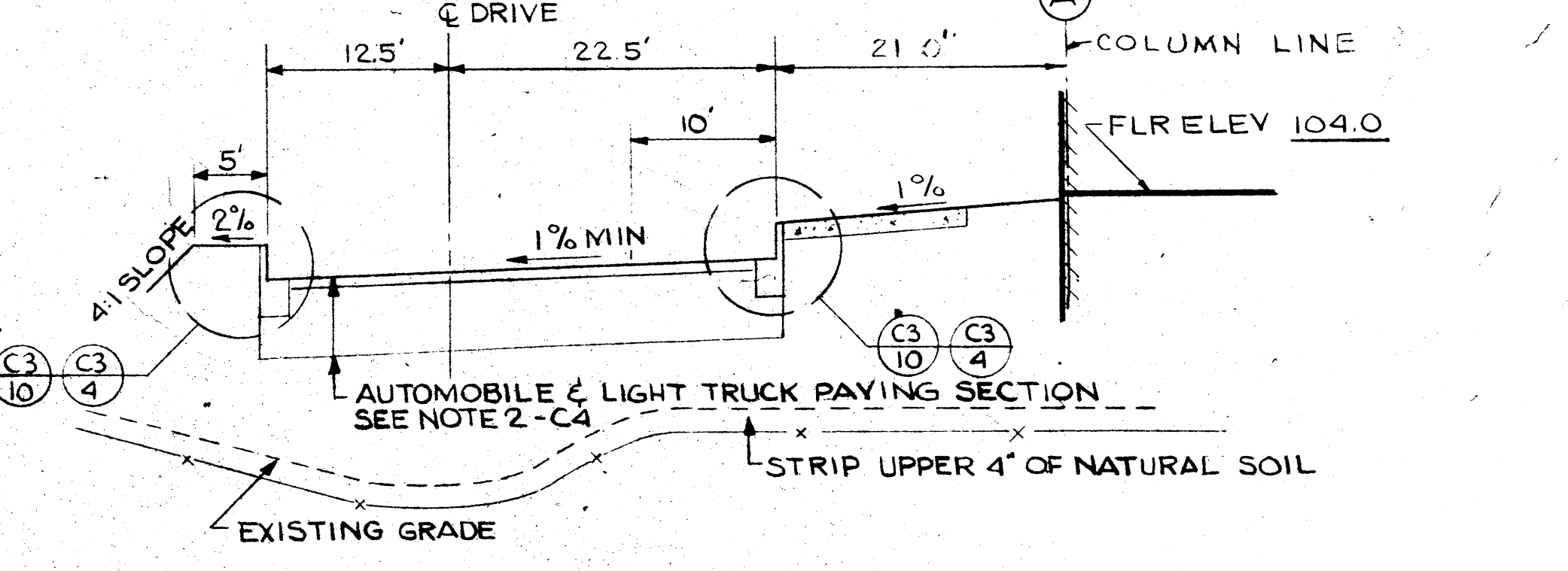

CB 10 TYPICAL DRIVE & DROP-OFF SECTION
NO SCALE

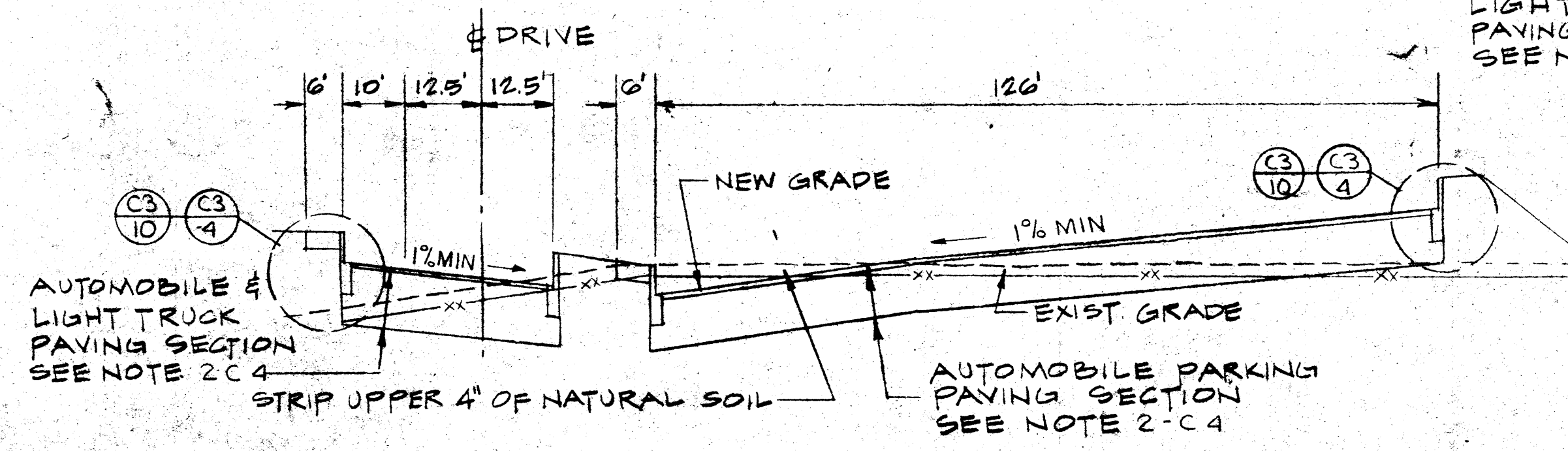

CB 8 TYPICAL DRIVE & PARKING SECTION
NO SCALE

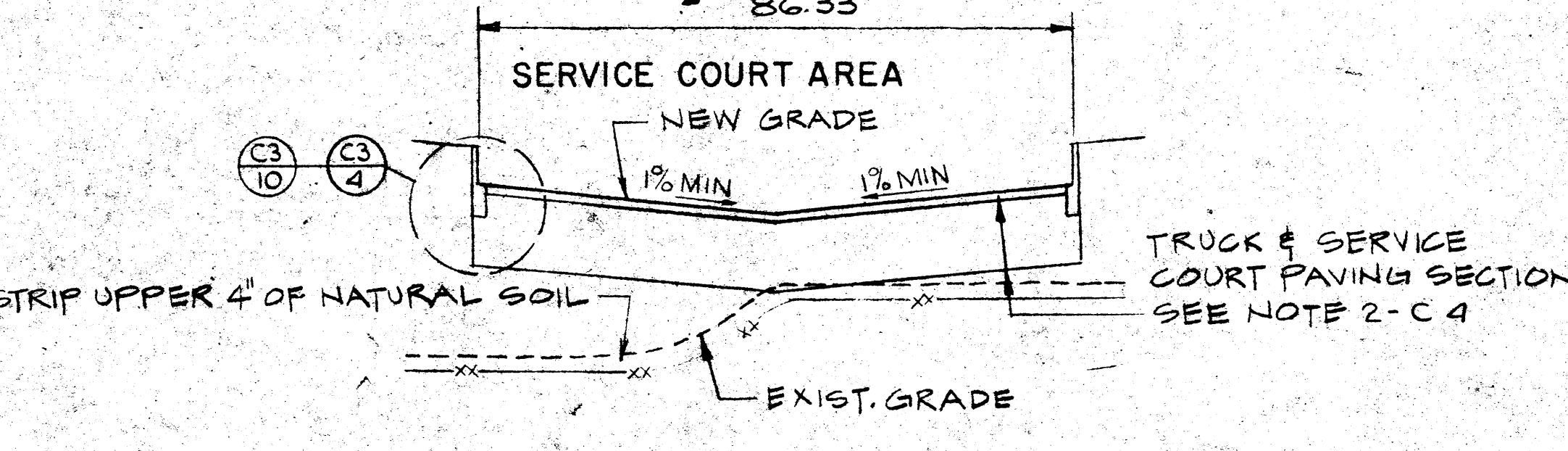

CB 11 SERVICE COURT AREA SECTION
NO SCALE

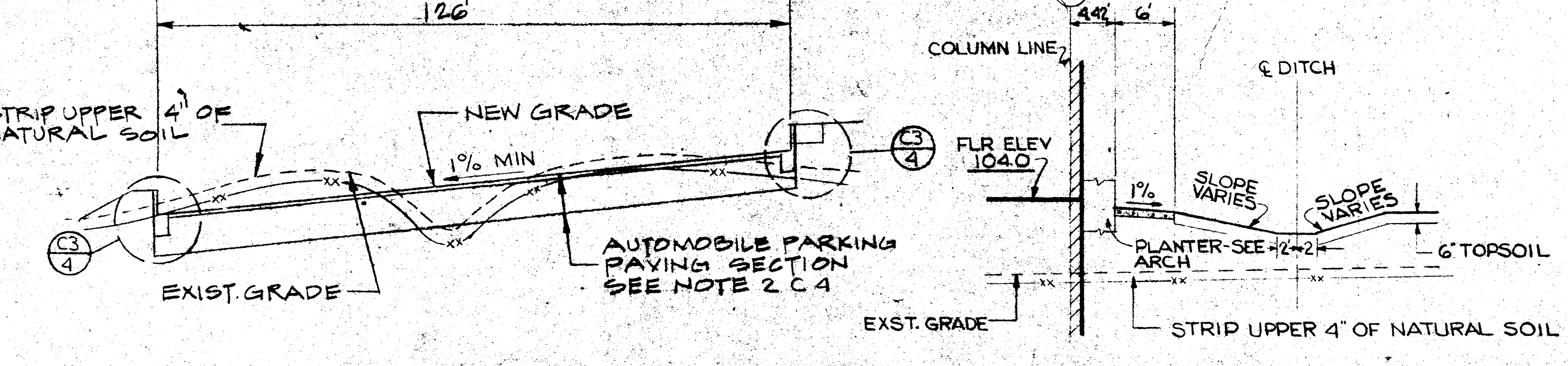

CB 12 TYPICAL PARKING SECTION
NO SCALE

CB 13 DITCH SECTION
NO SCALE

NOTES:
1. IMPORTED SELECT FILL SHALL BE USED UNDER ALL SIDEWALK AND PAVEMENT AREAS.
2. SEE NOTE 2 SHEET C4 FOR PAVEMENT SECTIONS.

REVISION	DATE	NUMBER
	5-20-76	JDB
PROFILES & SECTIONS		
NORTHERN CALIFORNIA REGIONAL OFFICE ROHNERT PARK, CALIFORNIA		
DRAWN BY: RWG		
CHECKED BY: LWE		
STATE FARM MUTUAL AUTOMOBILE INSURANCE COMPANY BLOOMINGTON, ILLINOIS		
R.O. 39-1	COMM. NO. 5521-6220	SHEET NO.
WILLIAM R. SHANNON, JR., A.I.A. REGISTRATION NO. C4493 STATE OF CALIFORNIA		ONE APPLE TREE SQUARE BLOOMINGTON, MINNESOTA 55420
C8		
Ellerbe		

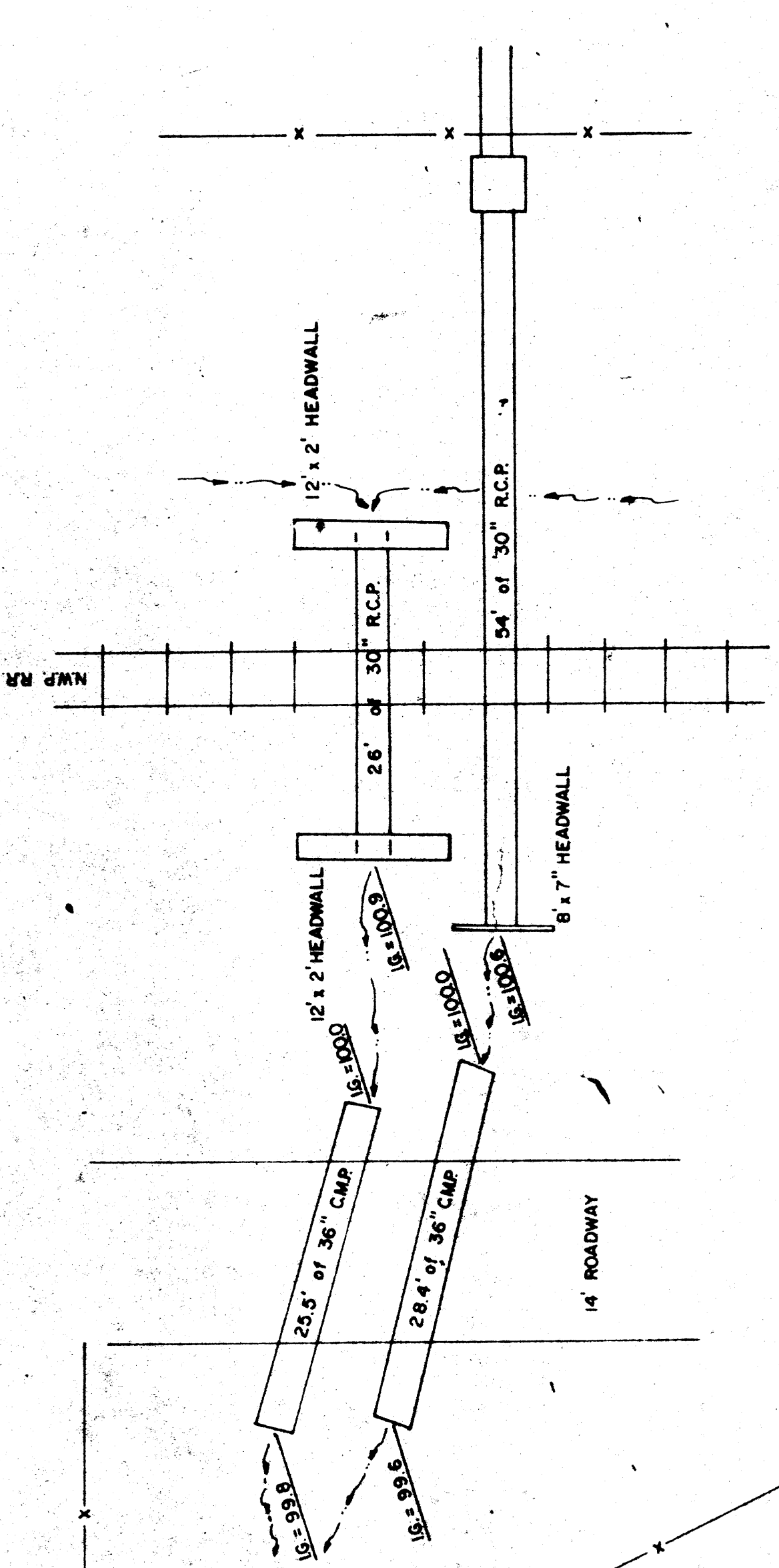
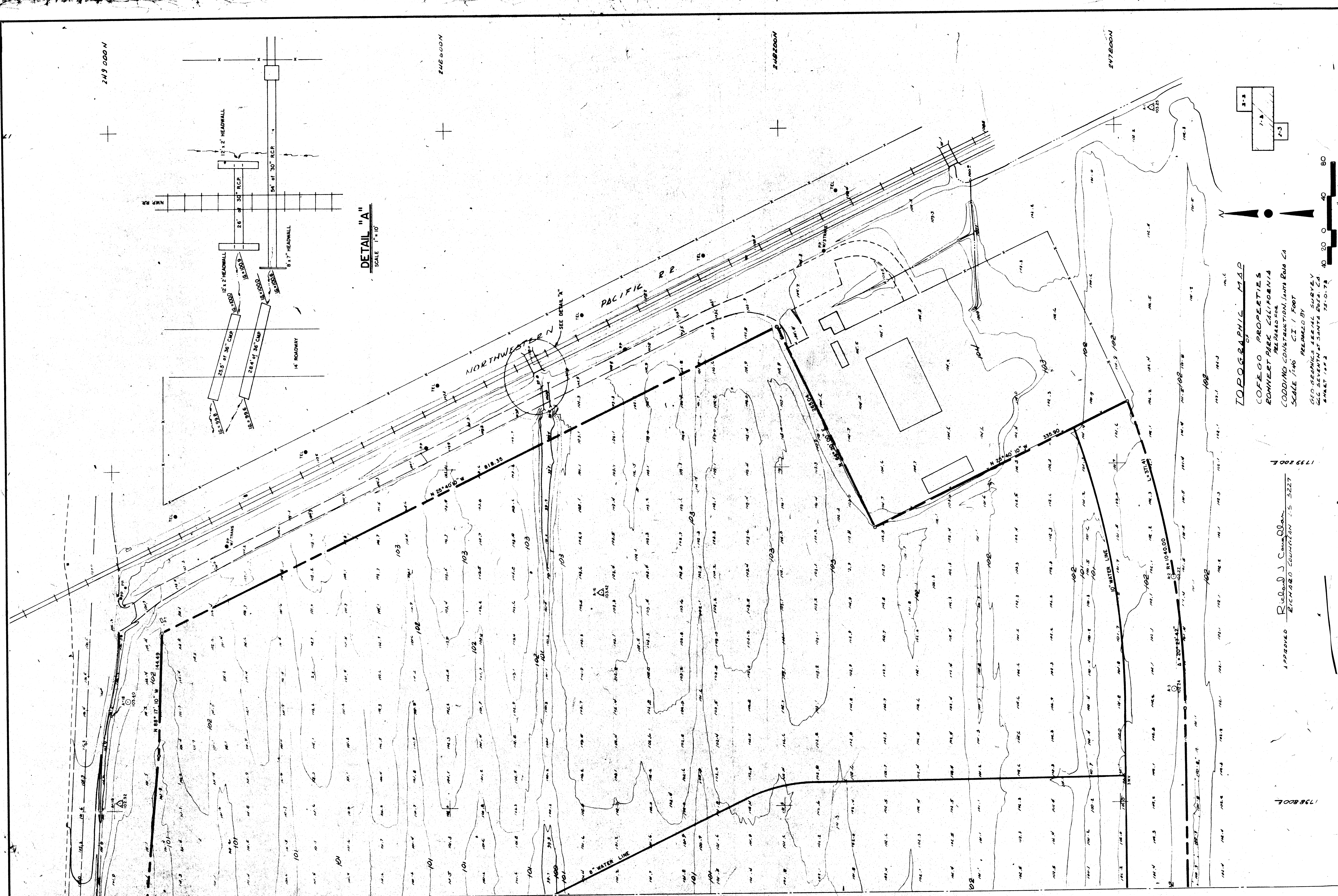

DETAIL "A"
SCALE 1"=10'

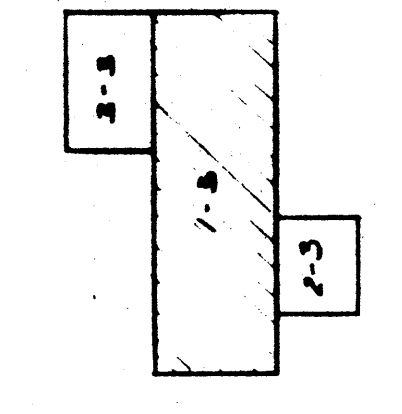

TOPOGRAPHIC MAP
 COFFEY PROPERTIES
 ROHNERT PARK CALIFORNIA
 PREPARED FOR
 CODDING CONSTRUCTION, JAMES EARL CA
 SCALE 1/40 C.I. / FOOT
 PREPARED BY
 GEO. GEORGE AERIAL SURVEY
 222 SEVENTH ST. SANTA ANA, CA
 SHEET 1738

APPROVED Richard Shannon
 LICENSED SURVEYOR NO. 3227
 1738 B.O.L.
 1739 B.O.L.

REVISION	DATE	NUMBER
ORIGINAL SURVEY	5-20-76	
NORTHERN CALIFORNIA REGIONAL OFFICE ROHNERT PARK, CALIFORNIA		
STATE FARM MUTUAL AUTOMOBILE INSURANCE COMPANY BLOOMINGTON, ILLINOIS		
R.O. 39-1	COMM. NO. 5521 622D	SHEET NO.
WILLIAM R. SHANNON, JR., A.I.A. REGISTRATION NO. C4483 STATE OF CALIFORNIA		ONE APPLE TREE SQUARE BLOOMINGTON, MINNESOTA 55408

C10

